



ETIBOX

Distribution Boards

Distribution boards DIDO **150**

Accessories **153**

f @ in v
/etigroup

ETI
SWITCH TO
A SAFE FUTURE

ETIBOX Distribution boards DIDO

Home distribution board DIDO-E

Rated current 63 A	Rated voltage 400 V	Degree of protection IP 40
------------------------------	-------------------------------	--------------------------------------



Technical data

Degree of protection	IP 40
Colour	white
Double insulation	
Standard	IEC 62208, IEC 60670-1, IEC 60670-24
Installation temperature	-25° / +60°C
Glow wire test	650°C

Number of N - PE terminals (1,5...16mm²):

ECT/M48PT/PO	2x20 20 PE / 20 N
ECT/M1x24PT/PO	2x13 13 PE / 13 N



Flush mounted distribution board - transparent door

Type	Code No.	Number of modules	 g		Rows
ECM48PT transparent door	001100400	48	2320	1/5	4

Flush mounted distribution board - white door

Type	Code No.	Number of modules	 g		Rows
ECM48PO white door	001100402	48	2320	1/5	4

Flush mounted distribution board 1x24 modules

Type	Code No.	Number of modules	 g		Rows
ECM 1x24PT transparent door	001100401	1x24	952	1/5	1
ECM 1x24PO white door	001100403	1x24		1/5	



Flush mounted distribution board

type	Dimensions							Max. allowed power losses when Max. number of devices are installed Pde	Static load
	A	B	C	D	E	F	G		
ECM48PT/ECM48PO	676 mm	283mm	106 mm	125 mm	273 mm	656 mm	68 mm	30W	1560 g
ECM 1x24PT/ECM 1x24PO	500 mm	255 mm	106 mm	125 mm	489 mm	235 mm	68 mm	30W	2340g

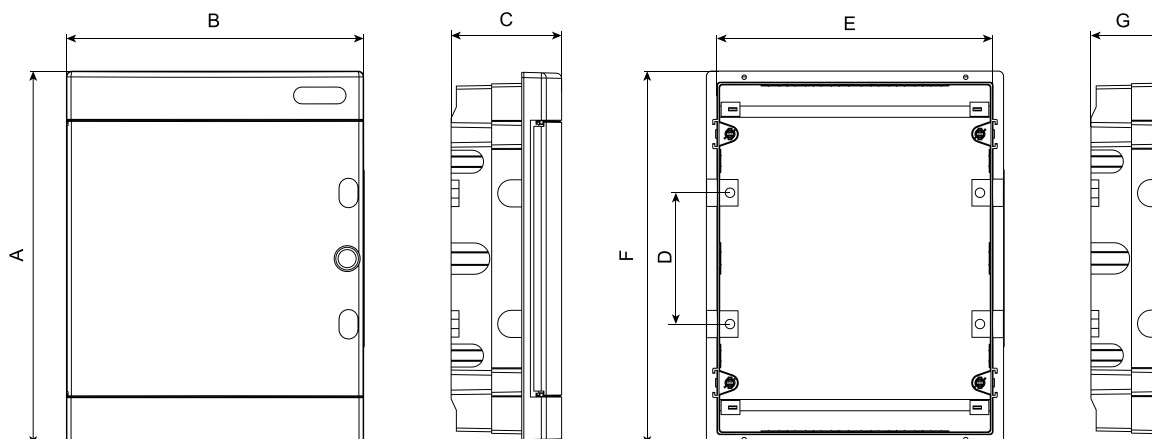

Flush mounted enclosures with super thin design DIDO ECG

Rated current
63 A

Rated voltage
400 V

Degree of protection
IP 40

Technical data

Degree of protection	IP 40
Colour	white
Double insulation	
Standard	IEC 62208, IEC 60670-1, IEC 60670-24
Installation temperature	-25° / +60°C
Glow wire test	650°C

Number of N - PE terminals (1,5...16mm²):

ECG56 2x20 20 PE / 20 N

- ECG56 and ECG70 have no extra space for PST-UNI terminals.

Flush mounted distribution board - plastic door - transparent

Type	Code No.	Number of modules			Rows
ECG56PT	001100412	48+8	3650	1/1	4

*Rear side plastics conforms 650°C glow wire test (not appropriate for wooden or hollow walls - IEC 60670-24)

Flush mounted distribution board - plastic door - white

Type	Code No.	Number of modules			Rows
ECG56PO	001100413	48+8	3650	1/1	4

*Rear side plastics conforms 650°C glow wire test (not appropriate for wooden or hollow walls - IEC 60670-24)

Flush mounted distribution board

Type	Dimensions					Max. allowed power losses when Max. number of devices are installed
	A	B	C	H	W	
ECG56	673 mm	306 mm	87 mm	717 mm	346 mm	60 W

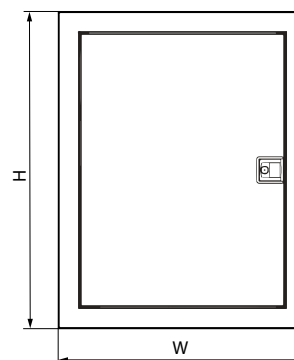
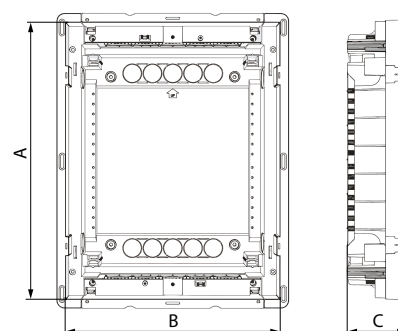

ECG

Material	Acrylonitrile butadiene styrene
Color	RAL9003
Door	Acrylonitrile butadiene styrene
Color	Transparent & white
Glow wire test	650°C
Terminal holder	Self extinguish material (Glow wire test: 960°C)
Temperature	-25°C ... +60°C
Rated voltage	AC400V
Standard	IEC 62208, IEC 60670-1, IEC 60670-24
Halogen free	✓

Enclosures for multimedia and communication device DIDO ECG MEDIA

Rated current
63 A

Rated voltage
400 V

Degree of protection
IP 30

Technical data

Degree of protection	IP 30
Colour	white
Standard	IEC 62208, IEC 60670-1, IEC 60670-24
Installation temperature	-25° / +60°C
Glow wire test	650°C



Number of N - PE terminals (1,5...16mm²):

ECG56 2x20 20 PE / 20 N

- ECG56 and ECG70 have no extra space for PST-UNI terminals.



Flush mounted multimedia distribution board - plastic door - transparent

Type	Code No.	Number of mounting plates	 g	
ECG56MEDIAPT	001100415	4	3300	1/1



*Rear side plastics conforms 650°C glow wire test (not appropriate for wooden or hollow walls - IEC 60670-24)

Distribution boards DIDO ACT



DIDO ACT

Material	ABS
Color	RAL9003
Door	styrene acrylonitrile
Color	Transparent & white
Glow wire test	650°C
Terminal holder	Self extinguish material (Glow wire test: 960°C)
Temperature	-25°C ... +60°C
Rated voltage	AC400V
Standard	IEC 62208, IEC 60670-1, IEC60670-24
Halogen free	✓

Surface mounted distribution board - plastic door - transparent

Type	Code No.	Number of modules	 g		Rows
ACT48PT	001100410	48+8	2500	1/5	4

Surface mounted distribution board - plastic door - white

Type	Code No.	Number of modules	 g		Rows
ACT48PO	001100411	48+8	2500	1/5	4

	A [mm]	B [mm]	C [mm]	D [mm]	E [mm]	Max. allowed power losses when Max. number of devices are installed
ACT48	310	650	96	219	472	60W

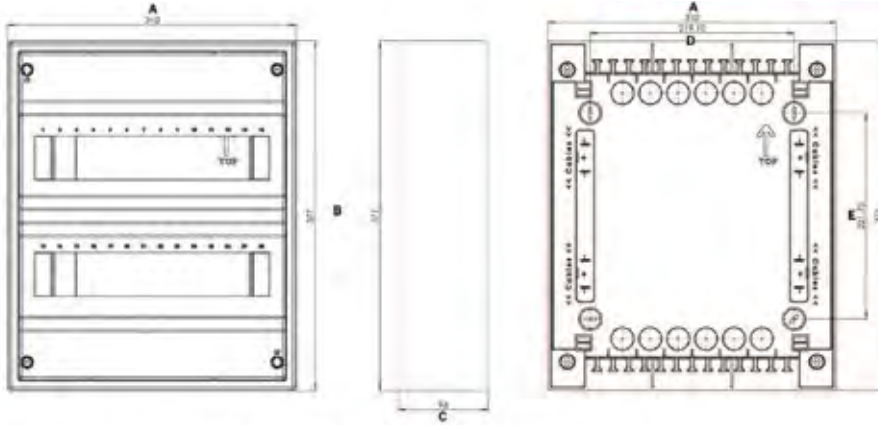

ETIBOX Accessories

Input Terminals EFB

EFB - 25 - F T - 15

1 2 3 4

1 - busbar cross-section (mm²): 25, 50.
 2 - connection type:
 F - fork type,
 P - PIN type.
 3 - cable entry:
 T - top; S - side
 4 - output length
 15...29mm



EFB-25FT-15



EFB-25FS-15



EFB-25PT-15



EFB-25PS-15



EFB-25FT-28



EFB-25FS-28



EFB-25PT-29



EFB-25PS-29

Feeding terminals EFB-25 (80A, AC 690/DC 1500V)

Type	Code No.	Cross-section [mm ²]	Type	Length [mm]	Entering	g	Box
EFB-25FT-15	002921280	6-25 mm ²	Fork	15	top	11	25
EFB-25FS-15	002921282		Fork	15	side	11	25
EFB-25PT-15	002921283		Pin	15	top	11	25
EFB-25PS-15	002921285		Pin	15	side	11	25
EFB-25FT-28	002921286		Fork	28	top	13	25
EFB-25FS-28	002921287		Fork	28	side	13	25
EFB-25PT-29	002921288		Pin	29	top	13	25
EFB-25PS-29	002921289		Pin	29	side	13	25

Feeding terminals EFB-50 (125A, AC 690/DC 1500V)

Type	Code No.	Cross-section [mm ²]	Type	Length [mm]	Entering	g	Box
EFB-50FT-15	002921281	6-50 mm ²	Fork	15	top	20	25
EFB-50PT-15	002921284		Pin	15	top	20	25

Input terminal for insulated conductor rails EFB-50 (160A, AC/DC 1000V)

Type	Code No.	Cross-section [mm ²]	Compatibility	Length [mm]	g	Box
EFB-50	002921278	6-50 mm ²	IZ (IZS) 17,8 mm	50	29	10



EFB-50FT-15



EFB-50PT-15



EFB50



3xEFB50

Dimensions

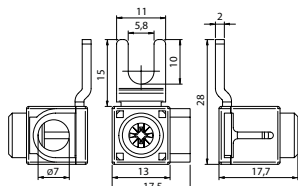

EFB-25FS-15

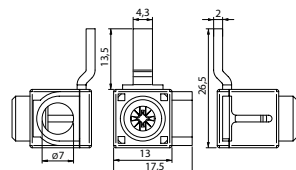

EFB-25PS-15

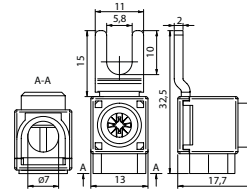

EFB-25FT-15

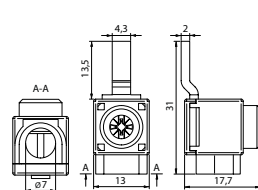

EFB-25PT-15

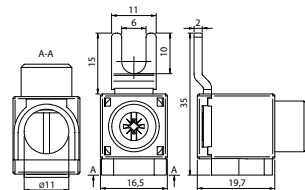

EFB-50FT-15

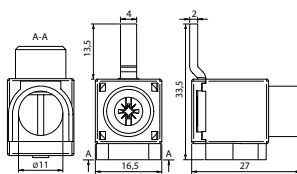

EFB-50PT-15

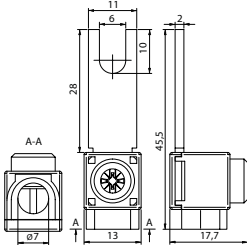

EFB-25FT-28

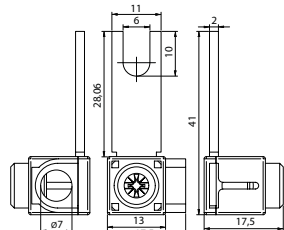

EFB-25FS-28

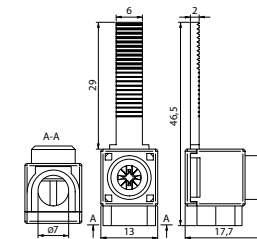

EFB-25PT-29

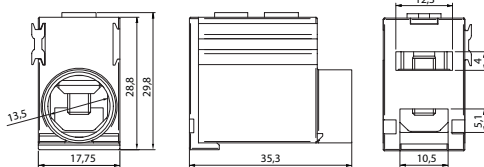

EFB-50

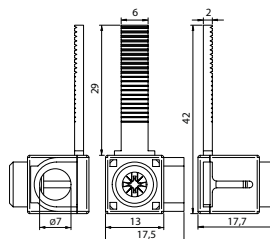

EFB-25PS-29

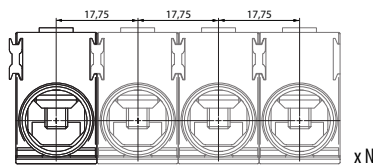

EFB-50

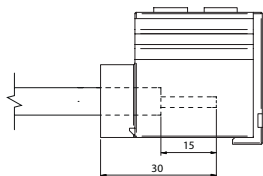

PZ2